



*Experience... Connect... Evolve...*

# Vacation Care Excursion Guide

## Contents

Your Lone Pine Learning Experience: What to Expect.....	1
Planning Your Day .....	1
Arrival.....	1
Discovery Package: Vacation Care .....	1
Free time exploration .....	2
General public daily talks and activities.....	2
Leader Checklist .....	3
How to Create an Itinerary .....	4
Treasure Hunt Worksheet.....	5
Treasure Hunt Cheat Sheet.....	7
Common Terminology .....	8

## Questions?

**Office hours: Monday to Friday, 8:00am to 4:00pm**

**T: (07) 3378 1366**

**E: [education@koala.net](mailto:education@koala.net)**

**W: [lonepinekoalasanctuary.com](http://lonepinekoalasanctuary.com)**

# Your Lone Pine Learning Experience: What to Expect

## Planning Your Day

It is expected you will have made an itinerary and printed Lone Pine maps to assist your supervisory team of teachers and chaperones with a smooth, enjoyable excursion. This Excursion Guide has checklists for you and your chaperones as well as an example itinerary. A map is available online: <https://lonepinekoalasanctuary.com/interactive-map/>

Don't forget the Education Team is just an email or phone call away! We are your support crew to assist in creating the best possible experience for you, your students and supervisory team.

## Arrival

Lone Pine Koala Sanctuary opens at 9:00am.

On arrival our team will complete a record of attendance by signing off final numbers of chaperones (including staff, parents, and any accompanying adults) and students.

To be eligible for the education rate for chaperones and students, all participants must be included in one bulk payment, otherwise standard retail rates apply. You have the option to prior, on arrival or post excursion. If you are paying post excursion you will be issued with a 7-day invoice.

## Discovery Package: Vacation Care

If you have elected to have the Discovery Package option you will receive:

**30 minute exclusive Animal Encounters experience** held in one of our presentation areas. Please assemble at the designated meeting place at least five minutes prior to your education experience. The meeting place will be shown to your group on arrival to Lone Pine. One of Lone Pine's Wildlife Education Officer's will meet your group at the designated presentation area. During this experience, students will meet up to four animals, learn fun facts and get hands-on wherever possible.

**Free range animal food** will be pre-packed and waiting for your group at our under cover seating area. Please make sure whoever collects your food distributes the individual feed bags to all students, not just their smaller group. We recommend you allocate at least 30 minutes for this activity. Please observe the rules of entering the Kangaroo Reserve for this activity. The rules may be found on each gate to the Kangaroo Reserve. Groups that do not follow the rules will be asked to leave the area.

You are free to participate in the ***Vacation Care Treasure Hunt*** using the worksheet provided in this kit. Instructions are available on the worksheet. Simply print out the required number of worksheets and distribute to your students (don't forget pens and pencils to record your answers!) We have provided a Treasure Hunt Cheat Sheet in this kit. Print out and distribute the cheat sheet to your supervisory team. It is recommended you allocate 30-45 minutes for this activity. If you have booked the Discovery Package, your group may collect 'treasure' from the Souvenir Shop at the Exit (one treasure per student).

#### Free time exploration

When you are not participating in your booked Discovery Session OR if you have booked a self-guided excursion, you are free to explore the Sanctuary.

#### General public daily talks and activities

You are welcome to attend our General Public presentations during your visit. Please note that not all presentations are suitable for large groups. You can view our daily activities on our website here: <https://lonepinekoalas Sanctuary.com/whats-on/>

We recommend the Free Flight Raptor Show and Sheepdog Show for Vacation Care groups. If attending one of these shows, please arrive early and ensure that your group sits together to leave room for other guests.

- **Free Flight Raptor Show** - 10:30am & 12:30pm
- **Sheepdog Show** – 11:00am & 1:00pm

# Leader Checklist

We ask all leaders to complete this checklist ahead of your visit for a smooth, enjoyable excursion.

- Book your free of charge Lone Pine Koala Sanctuary pre visit inspection by emailing us at [education@koala.net](mailto:education@koala.net)**
- Create your itinerary for the day (see page 4 for assistance)**
  - Print the online map and plan your visit by marking significant locations, meeting times, and walking routes.
  - Schedule your toilet and meal breaks, exploring time and public talks around your booked Discovery Sessions.
- Create and prepare your supervisory team**
  - All chaperone numbers (staff and any additional adults) must be confirmed with the Education Team at least 10 working days before your excursion.
    - Special needs students receive a free of charge ratio of 1 adult/student  
A carers card or letter from the centre manager is required stating that this level of care is needed for students with special needs
    - Vacation care students receive a free of charge ratio of 1 adult/8 students
  - Copy the Leader Checklist, Treasure Hunt worksheet, Treasure Hunt cheat sheet, map and the itinerary (created by you) for each chaperone in your supervisory team.
  - Discuss your excursion plan with your supervisory team before you leave your centre.
- Arrange payment with your centre's accounts payable team**
  - To be eligible for the education rate for chaperones, students and additional extras, all participants must be included in one bulk payment otherwise standard retail rates apply.
- If you are bringing lunches plan to store them in the undercover eating area near the Koala Forest area**
  - Storage space is available on a first-come, first-served basis at no charge.
  - Please store your lunches in eskies and 'turkey safe' boxes with lids.
- Review the following rules with your group**
  - Walk instead of run.
  - Outside the education officer guided experience, do not feed or interfere with wild or captive animals in any way.
  - Maintain quiet, calm behaviour around animals.
  - No flash photography, unless further than one metre from the animal. The use of flash photography within the Platypus House is strictly prohibited.
  - Help us maintain clean grounds by placing all rubbish in the bins provided.
  - Respect other guests in the Sanctuary.
  - Groups that do not respect Lone Pine's rules may be asked to leave and future bookings may be affected.

## How to Create an Itinerary

A great way to plan your day is to take advantage of your free pre-excursion visit. This will give you a good idea of distance between locations, suitable routes, shady locations, toilets and risk.

When creating your itinerary, don't forget to consider:

- Travel time between locations
- Toilet breaks
- Food and water breaks
- General public activities
  - Some general public activities are not suitable for large groups to attend, please check with the Education Team prior to your excursion to avoid disappointment.
- If you have booked the Discovery Package, make sure you include
  - Your pre-booked Discovery Sessions (see confirmation email for session times)
  - Free-range animal feeding

Your itinerary might look something like this:

<b>9:30am</b>	Arrival, sign off and read welcome from Education Officer
<b>9:50am</b>	Orient yourself to the Sanctuary and find the undercover seating area
<b>10:00am</b>	Morning tea & toilet break
<b>10:30am</b>	Discovery Session experience
<b>11:00am</b>	Public presentation – Sheepdog Show*
<b>11:20am</b>	Visit Reptile and Amphibian Habitat
<b>11:30am</b>	Visit Brisbane Koala Science Institute
<b>11:45am</b>	Free time
<b>12:00pm</b>	Free range animal feeding
<b>12:20pm</b>	Walk to Free-flight Raptor show area
<b>12:30pm</b>	Public presentation – Free flight Raptor Show*
<b>12:45pm</b>	Lunch & toilet break
<b>1:15pm</b>	Free time (visit over 70 native species!)
<b>2:00pm</b>	Depart Lone Pine

\*Not all public presentations are suitable for groups over 80 people. And some smaller activity venues are not suitable for groups over 15 people. Please check with the Education Team before including public presentations in your itinerary. Public activity times correct at time of printing.

# Treasure Hunt Worksheet

**Instructions:** Solve the clues and follow them around the Sanctuary. Continue until you have recorded all of the answers! If you have booked the Discovery Package (not self-guided) collect your Treasure from the Souvenir Shop at the Sanctuary Exit.

**Clue 1:** I have an extra thumb on each hand to help me climb trees. I live with the oldest of my species at Lone Pine.

**Answer 1:** .....

**Clue 2:** I'm known for being a bit noisy so listen up and you might just hear me. My yellow crest also helps me to communicate. **Answer 2:** .....

**Clue 3:** I love to run and can travel up to 60km a day when I'm helping out on the farm.

**Answer 3:** .....

**Clue 4:** My hard shell protects me from predators and my webbed feet help me swim in my natural habitat.

**Answer 4:** .....

**Clue 5:** I am Australia's largest carnivorous marsupial. I am known for my shrieking sounds, black and white fur and bright red ears. **Answer 5:** .....

**Clue 6:** My ginger fur helps me camouflage in my natural arid habitat. My closest relative is the wolf.

**Answer 6:** .....

**Clue 7:** I like to spend my time in water but I am not an amphibian. I can store fat in my brown, furry tail.

**Answer 7:** .....

**Clue 8:** I am a small grey bird with a crest on my head. If I am a male, I have a bright red head! I like to make my nests in tree hollows. **Answer 8:** .....

**Clue 9:** When I am not flying my sharp claws help me hang upside down. I live on a diet of fruit and vegetables; you might hear me calling at night. **Answer 9:** .....

**Clue 10:** My long claws allow me to easily climb trees. I use my forked tongue to collect smells from the air and I lay my eggs in termite mounds. **Answer 10:** .....

**Clue 11:** My wet green and yellow speckled skin helps me hide in my Rainforest habitat. I live in water and on land.

**Answer 11:** .....

**Clue 12:** I can have up to 72 sharp teeth located in my long, narrow mouth. I live in freshwater wetlands, billabongs, rivers and creeks. **Answer 12:** .....

**Clue 13:** I am the heaviest bird in Australia and can weigh up to 70kg. I am covered in black feathers and have a red and blue head with a helmet on top. **Answer 13:** .....

**Clue 14:** My very large feet help me hop up to 32kms an hour. Due to my long tail, I cannot jump backwards.

**Answer 14:** .....

**Clue 15:** I just love to dig in the dirt! You will often find me lying on my back having a rest in my burrow.

**Answer 15:** .....

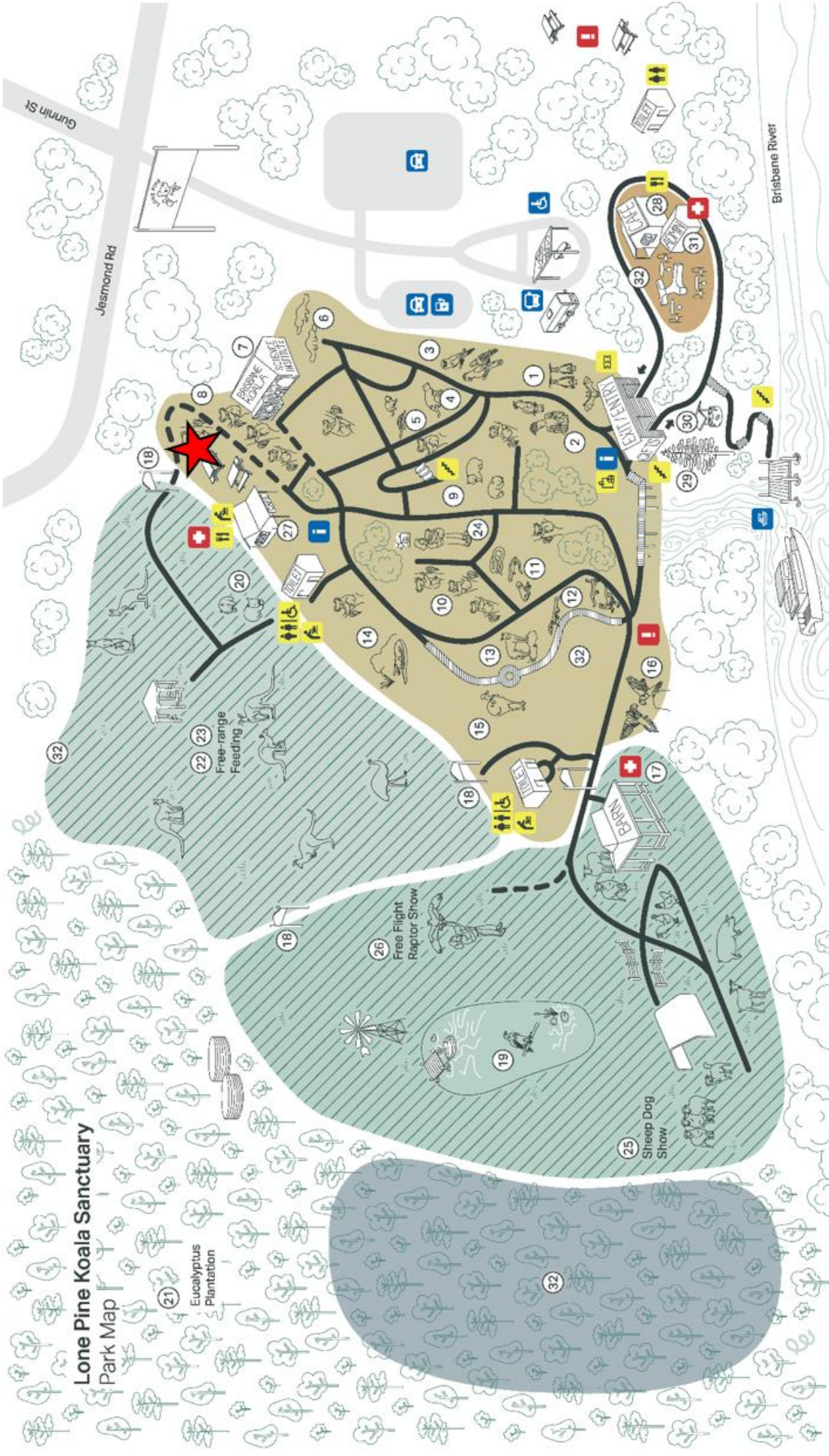

**Lone Pine Koala Sanctuary**  
Park Map

- ANIMALS**
  - 1 Flying Foxes
  - 2 Birds
  - 3 Birds
  - 4 Tasmanian Devils
  - 5 Turtles
  - 6 Platypus
  - 7 Brisbane Koala Science Institute
  - 8 Koala Forest
  - 9 Common Wombats
  - 10 Main Koala Exhibit
  - 11 Amphibian & Reptile Habitat
  - 12 Perentie, Water Monitor & Lace Monitor
  - 13 Dingoes
  - 14 Freshwater Crocodiles
  - 15 Cassowary
  - 16 Wild Lorikeet Feeding
  - 17 Barn Animals
  - 18 Kangaroo Reserve Entry/Exit
  - 19 Wedge-tailed Eagle
  - 20 Southern Hairy-nosed Wombats
  - 21 Eucalyptus Plantation
  - 22 Kangaroos, Wallabies & Emus
  - 23 Free-range Feeding Opportunities
  - 24 Wildlife Photo
  - 25 Sheep Dog Show
  - 26 Free Flight: Raptor Show
  - 27 Cafe
  - 28 Riverside Cafe
  - 29 The Lone Pine
  - 30 Wishing Well
  - 31 Administration
  - 32 Coming Soon!
- ACTIVITIES**
  - 23 Free-range Feeding
  - 24 Wildlife Photo
  - 25 Sheep Dog Show
  - 26 Free Flight: Raptor Show
  - FOOD & BEVERAGE**
  - 27 Cafe
  - 28 Riverside Cafe
- OTHER**
  - 29 The Lone Pine
  - 30 Wishing Well
  - 31 Administration
  - 32 Coming Soon!
  - EMERGENCY**
  - First Aid
  - Emergency
  - Assembly Area
- ICONS**
  - Information
  - Bus Stop
  - Car Park
  - Boat Jetty
  - Electric Car Charging Station
  - Entry / Tickets
  - Gift Shop / Exit
  - Cafe
  - Toilets
  - Baby Change
- ACCESSIBILITY**
  - Sleep Incline
  - Paved Path
  - Unpaved
  - Stairs

Undercover seating area and bag storage (first come, first serve)



# Treasure Hunt Cheat Sheet

**Clue 1:** I have an extra thumb on each hand to help me climb trees. I live with the oldest of my species at Lone Pine.

**Answer 1:** Koala, retirement exhibit

**Clue 2:** I'm known for being a bit noisy so listen up and you might just hear me. My yellow crest also helps me to communicate.

**Answer 2:** Sulphur-Crested Cockatoo

**Clue 3:** I love to run and can travel up to 60km a day when I'm helping out on the farm.

**Answer 3:** Kelpie

**Clue 4:** My hard shell protects me from predators and my webbed feet help me swim in my natural habitat.

**Answer 4:** Freshwater Turtle

**Clue 5:** I am Australia's largest carnivorous marsupial. I am known for my shrieking sounds, black and white fur and bright red ears.

**Answer 5:** Tasmanian Devil

**Clue 6:** My ginger fur helps me camouflage in my natural arid habitat. My closest relative is the wolf.

**Answer 6:** Dingo

**Clue 7:** I like to spend my time in water but I am not an amphibian. I can store fat in my brown, furry tail.

**Answer 7:** Platypus

**Clue 8:** I am a small grey bird with a crest and large, broad wings. If I am a male, I have a bright red head! I like to flock together in large groups and make my nests in tree hollows.

**Answer 8:** Gang Gang Cockatoos

**Clue 9:** When I am not flying my sharp claws help me hang upside down. I live on a diet of fruit and vegetables; you might hear me calling at night.

**Answer 9:** Flying Fox

**Clue 10:** My long claws allow me to easily climb trees. I use my forked tongue to collect smells from the air and I lay my eggs in termite mounds.

**Answer 10:** Lace Monitor

**Clue 11:** My wet green and yellow speckled skin helps me hide in my Rainforest habitat. I live in water and on land.

**Answer 11:** Magnificent Tree Frog

**Clue 12:** I can have up to 72 sharp teeth located in my long, narrow mouth. I live in freshwater wetlands, billabongs, rivers and creeks.

**Answer 12:** Freshwater Crocodile

**Clue 13:** I am the heaviest bird in Australia and can weigh up to 70kg. I am covered in black feathers and have a red and blue head with a helmet on top.

**Answer 13:** Southern Cassowary

**Clue 14:** My very large feet help me hop up to 32kms an hour. Due to my long tail, I cannot jump backwards.

**Answer 14:** Kangaroo

**Clue 15:** I just love to dig in the dirt! You will often find me lying on my back having a rest in my burrow.

**Answer 15:** Wombat (exhibit in the Kangaroo Reserve).



# Common Terminology

<b>Adaptations</b>	Features of an animal that enable it to survive in its environment.
<b>Amphibian</b>	An animal that can live on land and in water. They have moist skin through which they are capable of breathing. Frogs are the only amphibians found in Australia.
<b>Bird</b>	An animal that has four limbs- the front pair developed into wings. The bird's skin is covered in feathers and the female lays hard-shelled eggs.
<b>Camouflage</b>	A disguise that allows an animal to blend into its environment.
<b>Carnivore</b>	An animal that eats meat.
<b>Conserve</b>	To keep from harm or to protect.
<b>Ectotherm</b>	An animal whose body temperature changes with the temperature of the environment – reptiles.
<b>Endotherm</b>	An animal whose body temperature remains the same despite the temperature of its environment.
<b>Habitat</b>	The place an animal lives in its environment.
<b>Herbivore</b>	An animal that eats plants e.g. herbs and grasses.
<b>Joey</b>	A baby marsupial.
<b>Macropod</b>	A marsupial that has strong legs and big feet e.g. kangaroos.
<b>Mammal</b>	An endothermic vertebrate with hair, that feeds its baby milk from a mammary gland.
<b>Marsupial</b>	A mammal whose young is born in an underdeveloped state after a short pregnancy. The young complete their development inside a permanent or temporary pouch.
<b>Monotreme</b>	A mammal that lays soft-shelled eggs and feeds its young on milk produced from mammary glands on its stomach E.g. short-beaked echidna and platypus.
<b>Nocturnal</b>	An animal that sleeps during the day and is active at night.
<b>Omnivore</b>	An animal that eats meat and plants.
<b>Placental</b>	An animal that keeps its baby inside their body until it is well developed, by means of a placenta.
<b>Predator</b>	A carnivore that hunts other animals for food.
<b>Prey</b>	An animal that is eaten by other animals for food.
<b>Reptile</b>	An ectothermic vertebrate with dry skin covered in scales.
<b>Vertebrate</b>	An animal with a backbone.
<b>Young</b>	A baby animal.